

Visiting Universities Mexico >

Barcelona y

Londres

Junio 3-28, 2024

Costo: €1750



REGENERATION AND SUSTAINABILITY: Bon Pastor-Besos, BCN; Silvertown-Thames, LND



DIRECCION:

Dr. Juan Carlos Sánchez Tappan
www.espacio-sofar.org
info@espacio-sofar.org

GERENCIA:

SOFAR Academy /CAM-SAM

PROGRAMA:

- Taller de proyectos: 56 hrs. (SOFAR + BR)
- Seminario Sistemas Urbanos: 32 hrs. (CCCB, ISGlobal, Matter FAD)
- Viaje a Londres: 24 hrs. Junio 14-17

COLABORADORES

SEDE: <https://arriolafoi.com>



Network:

BARCELONA > LONDON

Experts in Barcelona



Dr. Juan Carlos
Sánchez Tappan
Dir.SOFAR
Academy



Dr. Xavier Costa
Guix (Prof.
Northeastern
Univ)



Jordi Castelló
Coordinador de
proyectos Barcelona
Regional



David Bravo
Bordas CCCB



Alvaro García
MYAA.



Dra. Sasha
Khomeiko,
ISGlobal



Tamara Lungman,
ISGlobal



Dra. Alexandra
Bretones, Univ.
Autonoma de BCN



Laura Hidalgo,
ISGlobal

Experts in London



Ricardo Sosa
Mejia, Senior
Assoc. at
Heatherwick



Alfredo Ramirez
Dir. AALU



Edgar Payan
Assoc. Z.H. Archs.



Neil Deely, leading
Urban Planner at
Carpenter State

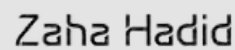

Ésta edición se enmarca en la temática del congreso de arquitectura que organiza el CAM-SAM: "ARQUITECTURA, TERRITORIO E INFRAESTRUCTURA: Forjando la Identidad Urbana."

"The New Green Deal", Europa primer continente neutro-ambiental en 2050. El programa exploró situaciones en el ámbito metropolitano y a escala de barrio, de arquitectura y urbanismo infraestructural, con el fin de descubrir estructuras y generar propuestas que integren las tres dimensiones.

Introduction & presentation

BCN: J03



Introducción:

Dr. Juan Carlos Sánchez Tappan

Dir. SOFAR Academy

Arq. Rodolfo Sánchez

Pnte. CAM-SAM.

Carmen Fiol

Arriola+Fiol

Presentación de profesores de las asignaturas:

- > "Design Research Studio" (DRS)
- > "Urban Systems Seminar" (USS) y
- > "London In Situ" (LND)



Presentación: Design Research Studio (DRS)

Dr. Juan Carlos Sánchez Tappan *SO FAR Academy*

Jordi Castello *Barcelona*

Regional, BR Green-Blue infrastructures in Bon Pastor: Sistemas de Flujos Condiciones de campo Urbanismo y arquitectura infraestructural para integración social, revitalización del tejido urbano, rehabilitación y nuevos usos de estructuras y espacios públicos, salud y sostenibilidad.





DEL 03 AL 28
DE JUNIO

2024

V.U.MEX > BARCELONA-LONDON
Dir. Juan Carlos Sánchez Tappan
**Urban regeneration < Green-Blue
Infrastructures in Bon Pastor,
Barcelona & Silvertown, London.**

Seminario Sistemas Urbanos

Charla inaugural:
Prof. Xavier Costa Guix



"Urbanismo Táctico"

Junio 3, 18 hrs. ECT
Mallorca 289, BCN. 08037

BCN: J03

Urban Systems Seminar (USS)

Key themes:

Tactical Urbanism
Nigel Henderson
Aldo Van Eyck
Fluxus Performances
Guy Debord, "The Naked City"
Constant, "Babylon"
Coop Himmelblau, "Instant Urbanism"
Bernard Tschumi
Park(ing) Day, 2005
Espace Culturel Écologique, "Passage 56"
MOMA, "Uneven Growth"
Ildefons Cerda, "Eixample" 1859
BCN, "Superblock"
Sally Harrison
<https://camd.northeastern.edu/people/xavier-costa/>



Sally Harrison, "Tactical Urbanism Where It Matters: Small-Scale Interventions in Underserved Communities." In Lillane Wong and Markus Berger, Interventions and Adaptive Reuse. Basel: Birkhauser, 2022, 176-184.



DEL 03 AL 28
DE JUNIO

2024

V.U.MEX > BARCELONA-LONDON

Dir. Juan Carlos Sánchez Tappan

Urban regeneration < Green-Blue
Infrastructures in Bon Pastor,
Barcelona & Silvertown, London.

Seminario Sistemas Urbanos

Prof. David Bravo Bordas

Sec. del jurado del premio europeo
del espacio público urbano, CCCB

"Infraestructuras
calientes"

Junio 4, 16 hrs. ECT

Mallorca 289, BCN. 08037



BCN:J04

Urban Systems
Seminar (USS)

Key themes:

Infraestructuras calientes

Declaración de Emergencia Climática 2030: Reducción del 50 % de sus emisiones de gases de efecto invernadero. Temporal Gloria y de olas de calor sin precedentes y de la peor sequía jamás registrada. Retos: pérdida de biodiversidad, la escasez de alimentos, el desgaste del frente marítimo o la descarbonización de la movilidad.

<https://www.publicspace.org/en/team>

CCCB Centre de Cultura Contemporània de Barcelona

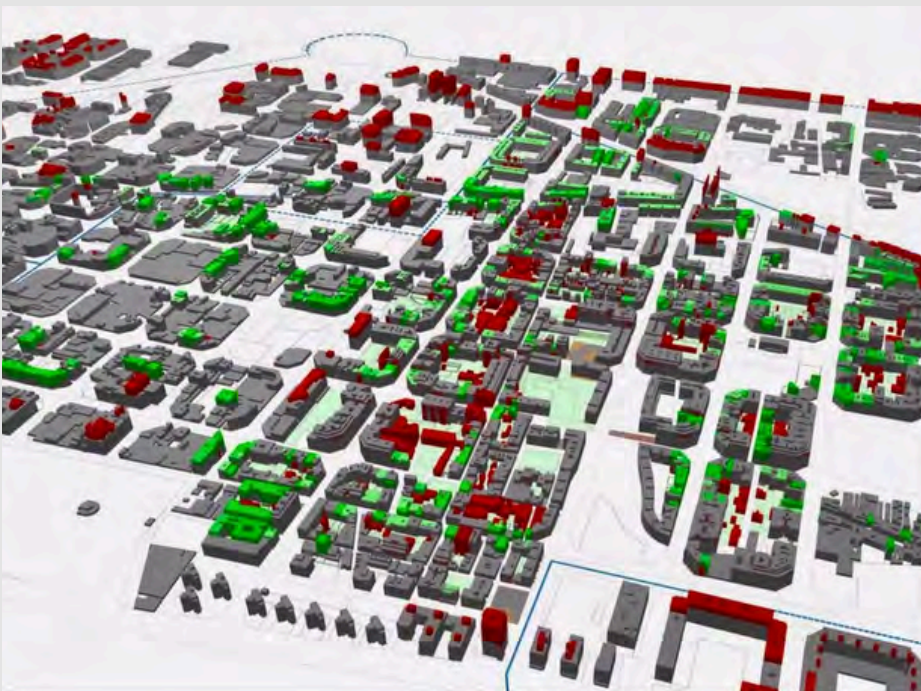

COLEGIO DE ARQUITECTOS DE LA CIUDAD DE MÉXICO
SOCIEDAD DE ARQUITECTOS MEXICANOS

SOFAR

STUDIO OF ARCHITECTURE RESEARCH



DEL 03 AL 28
DE JUNIO

2024

V.U.MEX > BARCELONA-LONDON
Dir. Juan Carlos Sánchez Tappan
**Urban regeneration < Green-Blue
Infrastructures in Bon Pastor,
Barcelona & Silvertown, London.**

**Seminario Sistemas Urbanos
Prof. Jordi Castello**

Coordinador de proyectos de espacio público, infraestructuras y paisaje en Barcelona Regional

"Territorio Besos"

Junio 5, 17 hrs. ECT
Carrer 60, 25-27. Edifici Z. 2a planta.



BCN:J05

**Design Research
Studio (DRS)**

Key themes:

1980-1986: Small scale.
1986-1992: Large scale.
Waterfront, residential and sports areas. Trans radial > periférica.
1992-2004: Metropolitan Scale. Infrastructure and strategic areas.

22>22@: 200 ha.=115manaz
Ind.Ed.: 2m2tech>2.7m2techo
Oc.Suelo:
70% 22@
10% Nuevos Eq. (7@)
10% Nvas. Viv. (HS)
10% Nvas Z.Verdes

Fórum: 45Ha, sup. trans:100Ha
Coste: 50% priv, 50% público.

Sagrera: parque 40 hectáreas
Rio Besos: parque fluvial. Sup:
35,75Ha



**DRS, In Situ visit to:
Barcelona Regional**

Agència pública de
planejament estratègic,
urbanisme i infraestructures
creada el 1993
<https://www.bcnregional.com>

Thanks to:

Dra. Bárbara Pons
Directora de Barcelona
Regional.

Jordi Castello



COLEGIO DE ARQUITECTOS DE LA CIUDAD DE MÉXICO
SOCIEDAD DE ARQUITECTOS MEXICANOS

SOFAR

STUDIO OF ARCHITECTURE RESEARCH

In Situ visit to:

BCN: J07

Design Research
Studio (DRS)

Barrio el Buen Pastor

Jordi Castello, BR

*Juan Carlos Sánchez
Tappan, SOFAR Academy*

Bon Pastor is a neighborhood in the Sant Andreu district located in northeast Barcelona on the banks of the Besòs River. The neighborhood has a deep cultural heritage and now faces the threat of gentrification caused by the private development of disused industrial buildings.



Antigua fábrica Mercedes-Benz

https://www.barcelona.cat/infobarcelona/es/tema/urbanismo-e-infraestructuras/la-transformacion-de-la-antigua-fabrica-mercedes-benz-fomentara-el-espacio-vecinal-a-sant-andreu_1207039.html





DEL 03 AL 28
DE JUNIO

2024

V.U.MEX > BARCELONA-LONDON
Dir. Juan Carlos Sánchez Tappan
Urban regeneration < Green-Blue
Infrastructures in Bon Pastor,
Barcelona & Silvertown, London.

Seminario Sistemas Urbanos
Dr. Lluís Domènech Amadó

Director de arquitectura Barcelona
Sagrera (B01 Arquitectos)

"Barcelona Sagrera"

Junio 11, 16 hrs. ECT
Baixada de la Sagrera, 2 5è
08030 - Barcelona



BCN: J11

Urban Systems Seminar (USS)

La estación central de la Sagrera será un centro estratégico del transporte en Cataluña. Conectará: alta velocidad, cercanías, metro, autobús interurbano, autobús urbano, taxi y vehículo privado. La urbanización de nuevas calles la integrarán en la ciudad y dos vías sepultadas la unirán directamente con las autopistas y las rondas. <https://barcelonasagrera.com/es/>



barcelona
sagrera
alta velocitat



Nuevas Conexiones



London In Situ: June 13-16



Royal Docks, King George V



Emirates cable car to Dome peninsula



El viaje, Londres In Situ, aportó la oportunidad de visitar infraestructuras rehabilitadas: los Royal Docks del distrito de Newham, y el Borough Market, el Tate Modern, la estación Battersea a lo largo del South Bank.

La experiencia de conocer procesos alternativos de diseño como investigación visitando destacadas practicas e instituciones: Heatherwick, Zaha Hadid, y el Architectural Association.

Thursday 13th

Heatherwick Studio
Kings Cross-St. Pancras train redevelopment

Friday 14th

LU Architectural Association
Zaha Hadid
Royal Docks, including the King George V lock, five bridges, impounding station

Saturday 15th

The London Centre
Borough Market
Southwark Underground Station

Sunday 16th. Free day.



In Situ visit to:

LND: J13

Heatherwick Studio

Thanks to: Ricardo Sosa Mejia, Senior Assoc.

Our world is losing its humanity. Too many developers care more about their shareholders than society. Too many politicians care more about power than the people who vote for them. And too many cities feel soulless and depressing, with buildings designed for business, not for us.
<https://heatherwick.com>



Broad Marsh, Nottingham, UK

A 20-acre regeneration plan including salvaging and repurposing the partially demolished shell of a 1970's shopping mall, reducing the waste and carbon emissions associated with new construction. The frame will provide space for a wide range of community uses including communal kitchens, theatres, learning spaces and sports facilities, creating a bridge between generations, communities and cultures.



In Situ visit to:

LND: J13

Kings Cross Regeneration

King's Cross is one of the largest and most successful redevelopments in London.

Over 20 years of transformation and rejuvenation of an Industrial site into new streets, squares and parks, homes, shops, offices, galleries, bars, restaurants, schools, and even a university.

The location, the connections, the canal-side setting, the **heritage**, an exciting cultural scene, a thriving business community, and a strong sense of local community.

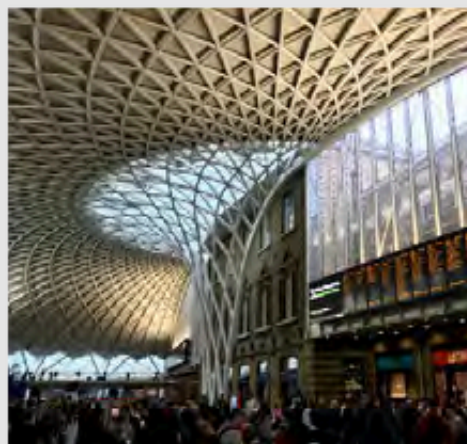

Coal Drops Yard, London, UK
An award-winning design that adapted industrial buildings from the 1850s to create a new public space and retail destination within an existing listed structure.

Comprehensively restoring the Victorian structures and yard,

Coal Drops



DEL 03 AL 28
DE JUNIO **2024**

V.U.MEX > BARCELONA-LONDON
 Dir. Juan Carlos Sánchez Tappan
Urban regeneration < Green-Blue Infrastructures in Bon Pastor, Barcelona & Silvertown, London.

London In Situ
 MArch. Alfredo Ramirez
 Co-founder and director of Ground-lab and currently director of the Landscape urbanism MA

"Ground Lab AA"

Junio 14, 9:30 hrs. UK time
 1 Montague St, London WC1B 5BP



LND: J14

London In Situ AA Landscape Urbanism

DESIGN AND POLICY IN THE CAPITALOCENE

Contemporary planetary urbanisation is structured by policies that respond to the dominant capitalist system governing our societies, economies and ecologies, which in turn have been shaped by human relations of power, production and environment-making. Agroecological urbanism Alternative land and asset ownership, and occupancy



Key themes:

- Pressures that Regional networks exert on localities today.
- The integration of natural processes and urban development into a sustainable artificial ecology.
- Cartographies of planetary urbanisation in remote landscapes
- Architectural and infrastructural facilities
- Bio-based materials and procurement systems

Thanks to:

Alfredo Ramirez
 1 Montague St. Studio,
 London WC1B 5BP

In Situ visit to:

LND: J14



Zaha Hadid Architects

Key Projects presented:

- Architecting the Metaverse in collaboration. with Refik Anadol Studio
- New Science Centre, Singapore
- Maxxi, Rome

Zaha Hadid



Thanks to: Edgar Payan and Paulo Flores

101 Goswell Rd Studio.,
London EC1V 7EZ.



In Situ visit to:

LND: J15



London New Architecture

The London Centre - is a public meeting space that houses our London-wide scale models and public galleries.



South Bank:

- Tate Modern
- Borough Market
- Southwark Underground Station
- The Shard and London Bridge station



In Situ visit to:

LND: J16

Serpentine Pavillion by Minsuk Cho, Mass Studies

Archipelagic Void, the Pavilion is composed of five 'islands', each structure is unique in size, height and form.

The curving edges of the individual roofs are conjoined by a steel ring which references traditional Korean houses that feature a madang, an open courtyard located at the centre.



Battersea Power Station

At its peak, Battersea Power Station was supplying a fifth of London's electricity. After decades of sitting derelict, it is now open to the public as one of London's most exciting and innovative new destinations. The very building which once produced the energy that enabled people to eat, drink, shop and play in the City, now provides the venue for a new generation to do the same.



ects Studio Work



DEL 03 AL 28
DE JUNIO

2024

V.U.MEX > BARCELONA-LONDON
Dir. Juan Carlos Sánchez Tappan
**Urban regeneration < Green-Blue
Infrastructures in Bon Pastor,
Barcelona & Silvertown, London.**

Alvaro Garcia
Head of Advanced Geometry
MYAA



"Sagrada Familia"

Junio 17, 16:30 hrs. UK time
Pau Claris 83, 1^{er}ª, Barcelona 08010

Urban Systems Seminar

Key themes: Templo expiatorio. Gaudi, místico católico La naturaleza como referencia.

MYAA is in working collaboration with The Sagrada Familia Foundation for 'Sacristy of the Nativity, Chapel of the Assumption and Cloisters'





DEL 03 AL 28
DE JUNIO

2024

V.U.MEX > BARCELONA-LONDON
 Dir. Juan Carlos Sánchez Tappan
Urban regeneration < Green-Blue Infrastructures in Bon Pastor, Barcelona & Silvertown, London.
 USS- ISGlobal
 Mstra. Tamara lungman,
 Dra. Sasha Khomenko

"Ciudades, medio ambiente y salud"

Junio 18, 18:00 hrs. ECT time
 calle Mallorca 289, BCN. 08037



Urban Systems Seminar

Entender los principales puntos urbanísticos y arquitectónicos del proyecto de las superillas y cómo se vincula a los determinantes de la salud.

- Plan Cerdà
- Superilla y la recuperación del espacio público
- Contrastes urbanísticos y sanitarios con otros barrios del centro de Barcelona
- Introducción a las
- Inequidades en ambiente y salud

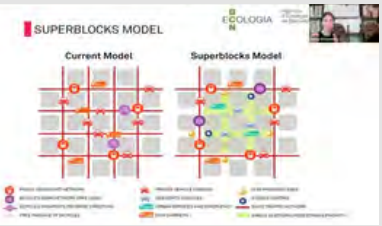
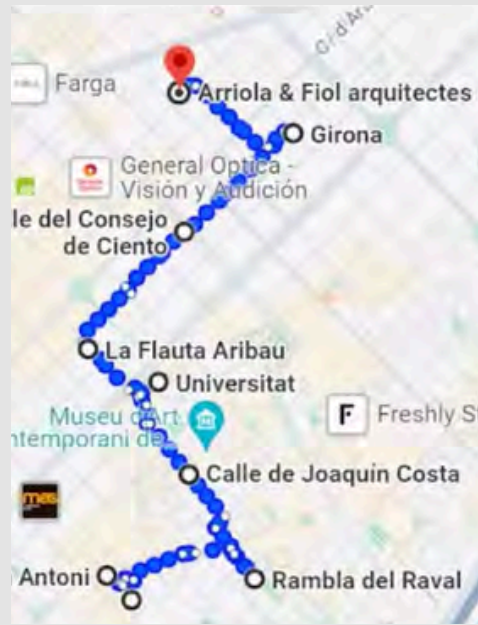



DEL 03 AL 28
DE JUNIO **2024**

V.U.MEX > BARCELONA-LONDON
Dir. Juan Carlos Sánchez Tappan
**Urban regeneration < Green-Blue
Infrastructures in Bon Pastor,
Barcelona & Silvertown, London.**

USS- ISGlobal: Laura Hidalgo
Dra. Alexandra Bretones



"Evaluación del espacio público"; "Sedentarismo, actividad física, movilidad y salud."

Junio 20, 16:30 hrs y 18 hrs
ECT time



ISGlobal Instituto de
Salud Global
Barcelona

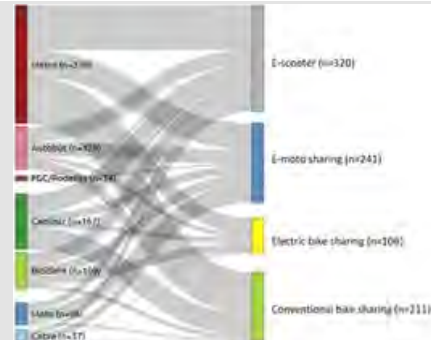
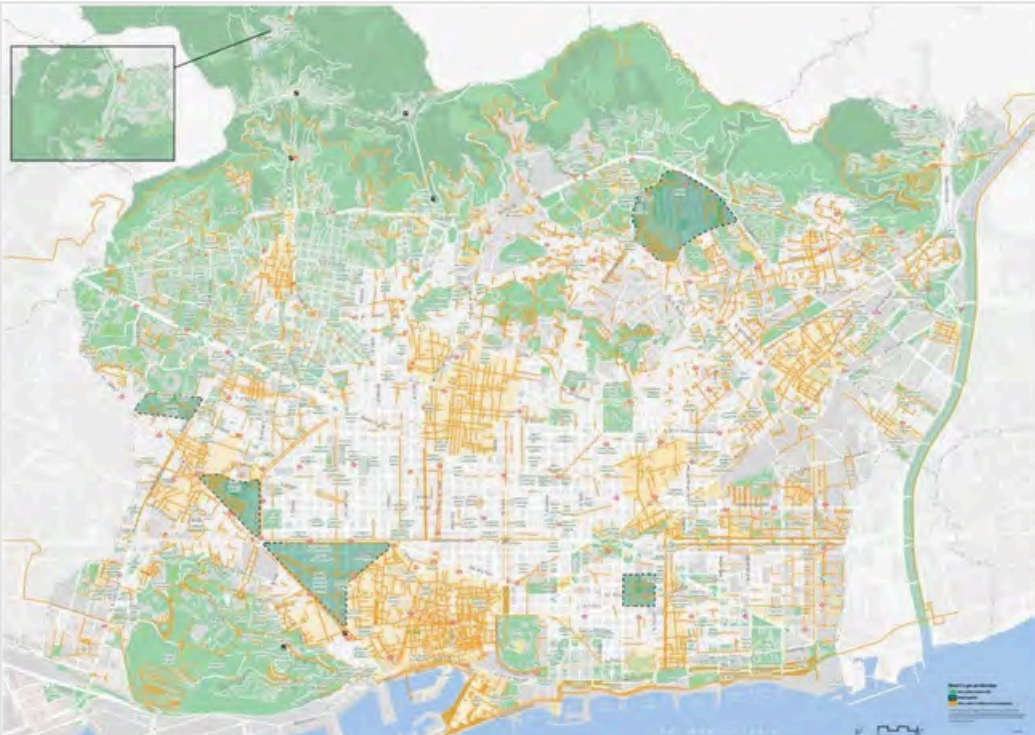

DE MOVILIDAD 2030



In Situ visit to:

BCN: J09



Urban Systems Seminar visits EDAR

La depuradora del Besòs està situada entre Sant Adrià de Besòs i Barcelona. Es tracta d'una de les depuradores cobertes integrades al teixit urbà més grans del món i la de més capacitat de processament de Catalunya.

Thanks to: **Gloria Sánchez, AMB**

Programas de tratamiento de residuos y reciclaje del agua.

 **AMB** : Àrea Metropolitana de Barcelona



Visita a planta de incineración de residuos y generación de energía. Aquesta planta depura un 36 % del total d'aigües residuals tractades pel conjunt de depuradores metropolitanos.



COLEGIO DE ARQUITECTOS DE LA CIUDAD DE MÉXICO
SOCIEDAD DE ARQUITECTOS MEXICANOS

SOFAR

STUDIO OF ARCHITECTURE RESEARCH



DEL 03 AL 28
DE JUNIO

2024

V.U.MEX > BARCELONA-LONDON

Dir. Juan Carlos Sánchez Tappan

Urban regeneration < Green-Blue
Infrastructures in Bon Pastor,
Barcelona & Silvertown, London.

Final Review (DRS):
"Urban Visions 2050"

Profs. Juan Carlos Sanchez
Tappan (SOFAR Academy)
Jordi Castello (B.R.)



Junio 28, 17:00-19 hrs. ECT
calle Mallorca 289, BCN. 08037

Gran Via al límit
Josep Parcerisa i Alvaro Clua

BCN: J03

Design Research Studio

Profs:

*Dr. Juan Carlos Sánchez
Tappan y Jordi Castello.*

Revisores In Situ:

*Rosa Maria Galimany
Coordinadora del Grupo
Territorial de l'Eixample del
Colegio de Arquitectos
(COAC)*

On Line:

*Antonia Washington,
U.Oregon*



24/7

Moisés Romano Elfon
Simon Tussie Bissu



KMO

Carolina Fernández-Pellón Valdés
Karla Danea Mena Sánchez



Alianza CAM-SAM Red en México



Arq. Rodolfo Sánchez Zaragoza
Presidente Consejos Directivos
CAM SAM 2023-2025

Collaborators:
Arq. Alejandro González
Arq. Dinorah



PhD. Juan Carlos Sánchez Tappan.
Principal in SOFAR
www.espacio-sofar.org

**Founder and Director of
VUMEX>BCN-LND**

Collaborators:
Pablo Carbonell
José Ramón Viza

Agradecemos especialmente a:

**Mtro. Gerardo Broissin Covarrubias, Dir. de la Facultad de Arq.
Anahuac**

Arch. José Manuel Alegría Peña, Facultad de Arquitectura, Anahuac

**Msta. Blanca vila Cartell, Directora de la Escuela de Diseño y
Arquitectura de la Anahuac Puebla**

Mtra. Stephanie Mendoza Prieto , Escuela de Arquitectura y Diseño



Previous editions:

2023-2020

VISITING UNIVERSITIES MEXICO AT:
FUNDACIÓ ENRIC MIRALLES
IN SITU 2023

BARCELONA Y LONDRES
JUNIO 1-30
COSTO: €1750



**BESÒS: RECYCLING TERRITORIES;
CARING ENVIRONMENTS IN BCN**

CO-DIRECTORS
Dlx. Juan Carlos Sánchez Tappan | SOFAR, MEX-BCN
MIRA, María Bustamante | FUNDARQMX, MEX-BCN

COORDINATORS
MEX: fundarqmx@gmail.com
BCN: info@espacio-sofar.org

COLLABORATORS
ARQ MEX, SOFAR, CCCB, ISGlobal, ETSAB

VISITING UNIVERSITIES MEXICO AT FUNDACIÓ ENRIC MIRALLES
BCN IN SITU 2022

BARCELONA AND LONDON
JUNE 1-30
PRICE: € 1650



**22@:SMART TERRITORIES,
HEALING ENVIRONMENTS**
VISITING UNIVERSITIES MEXICO

CO - DIRECTORS
Juan Carlos Sánchez Tappan | SOFAR, MEX-BCN
María Bustamante | FUNDARQMX

COORDINATION
MEX: fundarqmx@gmail.com
WA: +52 55 5415 6042
BCN: info@espacio-sofar.org
WA: +34 666 957 346

Design Research Studio: 56 hrs.
Urban Systems Seminar: 32 hrs.
London Study Travel: 24 hrs.

COLLABORATORS
ARQ MEX, SOFAR, CCCB, ISGlobal, ETSAB

Visiting Universities Mexico at
Fundacio Mies van der Rohe + UPC-ETSAB

Barcelona and London
June 1-30, 2021 - 1500 €



Back to the Seafront
Architectures for the BCN Forum Platform

CO-DIRECTORS
Juan Carlos Sánchez Tappan | FUNDARQMX-SOFAR, Mexico-Barcelona
Anna Ramos | Fundacion Mies van der Rohe, FMVDR, Barcelona
Hector Mendoza | UPC-ETSAB, Barcelona

COORDINATORS
SOFAR, Mexico-Barcelona
FUNDARQMX, Mexico
FMVDR, Barcelona
UPC-ETSAB, Barcelona

Design Research Studio (56 hrs.)
SOFAR + Barcelona Regional
Urban Research Seminar (32 hrs.)
FMVDR + ETSAB
London Virtual Field Trip (24 hrs.)
Prof. Juan Carlos Sánchez Tappan
SOFAR, Mexico-Barcelona

Mexico: +52 (55) 5563 7206
Barcelona: +34 (93) 215 10 11

COLLABORATORS
ARQ MEX, SOFAR, CCCB, ISGlobal, ETSAB

Visiting Universities Mexico at
Fundacio Mies Van Der Rohe
+ UPC-ETSAB

Barcelona and London
June 1-30, 2020
1.650 €



**Architectures for the BCN
sea front platform**

Co-Directors
Juan Carlos Sánchez Tappan | FUNDARQMX-SOFAR, Mexico-Barcelona
Anna Ramos | Fundacion Mies Van Der Rohe, FMVDR, Barcelona
Hector Mendoza | UPC-ETSAB, Barcelona

Coordination
SOFAR, Mexico-Barcelona
FUNDARQMX, Mexico
FMVDR, Barcelona
UPC-ETSAB, Barcelona

Design Research Studio (56 hrs.)
SOFAR + Barcelona Regional
Urban Research Seminar (32 hrs.)
FMVDR + ETSAB
London Study Travel (24 hrs.)
Prof. Juan Carlos Sánchez Tappan
SOFAR, Mexico-Barcelona

Mexico: +52 (55) 5563 7206
Barcelona: +34 (93) 215 10 11

COLLABORATORS
ARQ MEX, SOFAR, CCCB, ISGlobal, ETSAB

Previous editions:

2019, 2017

Visiting Universities Mexico at

FUNDACIÓ ENRIC MIRALLES

PRODUCTIVE SEA FRONT IN BARCELONA

NEW PROPOSALS FOR THE 'ZOO PLATFORM'



Barcelona and London
June 1-29, 2019

Co-Directors
Juan Carlos Sánchez Tappan | Studio Of Architecture Research, México-Barcelona
Benedetta Tagliabue | Miralles Tagliabue EMBT and Fundació Enric Miralles, Barcelona

1.650 €

Coordinators
Juan Carlos Sánchez Tappan | Studio Of Architecture Research, México-Barcelona | info@espacio-sofar.com
Anna Vilà | Fundació Enric Miralles, Barcelona | info@fundacioenricmiralles.com

Teaching Collaborators



PRODUCTIVE SEA · FRONT · BCN 2019

Compartir

3-28 junio 2019

SEA FRONT TERRITORIES ZOO PLATFORM BCN

VISITING UNIVERSITIES MEXICO-
BAU_BARCELONA/LONDON - SUMMER 2017

Director: MArch Juan Carlos Sánchez Tappan
Teaching collaborators: BAU and Barcelona
Regional, BIR
Design Research Studio (56 h)
Prof. Juan Carlos Sánchez Tappan, BAU + BIR
Urban Parametrics Seminar (32 h)
Prof. BAU + BIR
London Study Travel (24 h)
Prof. Juan Carlos Sánchez Tappan

Cost 1.650€

BARCELONA / JUNE 2017

CONTACT
Barcelona
+34 669 257 346
+34 934 153 474
Mexico
+521 5533970601
email
numen@bau.cat
jst@enquiro-sofar.org
www.bau.cat
www.fundacioenricmiralles.com
www.visiting-universities-mexico



V.MET.ROSA.

Previous editions:

2016-2013



SMART PUBLIC TERRITORIES BCN 2016

MEXICO VISITING SUMMER SCHOOL HOSTED AT IAAC

1 JUNE - 30 JUNE 2016
BARCELONA

PROGRAM 2016 // SMART PUBLIC TERRITORIES BCN 2016
BARCELONA // 1 JUNE - 30 JUNE 2016
DESIGN RESEARCH STUDIO: ESPACIO PUBLICO INTELIGENTE (56 hrs)
SEMINARIO: URBANISMO PARAMETRICO Y FABRICACION DIGITAL (32 hrs)
FIELD TRIP: LONDON (24 hrs)

Outside the taught hours, students are expected to work independently on each subject for the same amount of hours.

PRICE // 1650€

DIRECTOR // Juan Carlos Sánchez Tappan
Director of Mexico Visiting Summer School Festival at IAAAC

COORDINATOR // Aldo Solís
Head of IAAAC Visiting Programs

More info: jcs@espacio-solar.org
mexico@iaac.net
MEX: +52 155 3397 0601
BCN: +34 933209520
+34 933209520
<http://iaac.net/educational-programs/mexico-summer-school-2016-42>

Public: 151 0000, 010000
mexico-summer-school-2016-42

Iaac Institute for advanced architecture of Catalonia

MEXICO VISITING UNIVERSITIES SUMMER SCHOOL 2015

15 JUNIO-30 JULIO 2015

BCN Recycled Territories

BARCELONA

PROGRAM // DESIGN RESEARCH STUDIO: DISEÑO DE TERRITORIOS RECICLABLES(56 hrs)
SEMINARIO: URBANISMO PARAMETRICO Y FABRICACION DIGITAL(32 hrs) FIELD TRIP: LONDON (24hrs)



CASE STUDY // BARCELONA BESOS RIVER PRECIO // 1650€

DIRECTORS // Juan Carlos Sánchez Tappan (UIA, Mexico) Manuel Gausa (IAAC Dean, Barcelona)
Luis Fraguada (Master Director, Barcelona)

More info: MEX: jcs@espacio-solar.org
BCN: mexico@iaac.net
MEX: +52155 3397 0601
BCN: +34 933209520, +34 669357346

www.iaac.net/educational-programs/mexico-summer-school-2015-42

Iaac Institute for advanced architecture of Catalonia

Public: 020
010000 Barcelona
www.iaac.net
+34 933 209 520



MEXICO VISITING UNIVERSITIES SUMMER SCHOOL 2014

BCN RESET
IDENTITY, DIVERSITY, DESIGN

PROGRAM // DESIGN RESEARCH STUDIO: DISEÑO DE TERRITORIOS PATRIMONIALES(56 hrs)
SEMINARIO: URBANISMO PARAMETRICO Y FABRICACION DIGITAL(32 hrs)
FIELD TRIP: LONDON (18hrs) / STUDY TRAVEL: VENICE (6 hrs)

CASO DE ESTUDIO // BARCELONA RESET
PRECIO // 1650€

DIRECTORES // Juan Carlos Sánchez Tappan (UIA, Mexico) Manuel Gausa (IAAC Dean, Barcelona)
Areti Markopoulou (Master Director, Barcelona)

More info: MEX: jcs@espacio-solar.org
BCN: mexico@iaac.net
MEX: +52155 3397 0601
BCN: +34 933209520, +34 669357346

www.iaac.net/educational-programs/mexico-summer-school-2014-42

BARCELONA/ 2-30 JUNIO 2014

Iaac Institute for advanced architecture of Catalonia



MEXICO VISITING UNIVERSITIES SUMMER SCHOOL 2013

SISTEMAS URBANOS SOSTENIBLES

PROGRAM // DESIGN RESEARCH STUDIO: EL EIXAMPLE DEL SIGLO XXI (56 hrs)
SEMINARIO: URBANISMO PARAMETRICO Y FABRICACION DIGITAL(32 hrs)
VIAJE DE ESTUDIO: POST OLYMPIC LONDON (24hrs)

CASO DE ESTUDIO // BARCELONA 22@
PRECIO // 1650€

DIRECTORES // Juan Carlos Sánchez (Mexico) Manuel Gausa (IAAC Dean, Barcelona)
Areti Markopoulou (Master Director, Barcelona)

More info: MEX: jst_mexicosummerschool@iaac.net
m.5598 6772, m.322 147 2621
BCN: +34 933209520

www.iaac.net/educational-programs/mexico-summer-school-2013-29

BARCELONA/ 3-30 JUNIO

Iaac Institute for advanced architecture of Catalonia

Previous editions:

2012-2010



ELISAVA VISITING UNIVERSITIES BARCELONA-MÉXICO
www.elisava.net

Investigación

ARQUITECTURA E INTERIORISMO

Interculturalidad

Cultura urbana

Sustentabilidad

Diseño

Innovación

2ª edición
Inicio: 1 de junio de 2012
Créditos: 12 ECTS
Idioma: Castellano e Inglés
Dirección: Juan Carlos Sánchez Tappan

Los estudiantes del Departamento de Arquitectura de la Universidad Iberoamericana, Sta Fe, de México, conjuntamente con los alumnos de la universidad ITESO, Guadalajara, la Universidad Anahuac del Norte, DF y el ITESM, de Querétaro realizan en ELISAVA la segunda edición del curso de verano en Barcelona, dentro del marco de los programas de estudios académicos conjuntos Visiting Universities.

Los alumnos desarrollarán estudios de arquitectura entre Barcelona y Londres en junio de 2012 bajo la dirección de Juan Carlos Sánchez Tappan, Codirector de Visiting Universities, México-ELISAVA.

Área de Arquitectura e Interiorismo

ELISAVA Escola Superior de Disseny i Enginyeria de Barcelona

La Rambla 30-32
08002 Barcelona
T + (34) 93 317 47 15
F + (34) 93 317 83 53
elisava@elisava.net
www.elisava.net

Fundació Privada Elisava
Escola Universitària
Gran edifici de
Gremi d'edificadors
UNIVERSITAT POLITÈCNICA DE BARCELONA



UIA-ELISAVA | BARCELONA Junio 1-30, 2011

ELISAVA Escola Superior de Disseny i Enginyeria de Barcelona

PROGRAMAS INTERNACIONALES
<http://www.1961502011.net/es/oferta-formativa/programas-internacionales>

1961502011

La Rambla 30-32
08002 Barcelona
T + (34) 93 317 47 15
F + (34) 93 317 83 53
elisava@elisava.net
www.elisava.net

Fundació Privada Elisava
Escola Universitària
Gran edifici de
Gremi d'edificadors
UNIVERSITAT POLITÈCNICA DE BARCELONA

ITESO BCN < Verano 2010. Nuevas ecologías para el Eixample del siglo XXI, 22@.

Profesor: Juan Carlos Sánchez Tappan (UPC-FPC, ITESO)

Criticos Invitados: Pablo Vazquez Plombo (ITESO), Rafael Gomez Mórjana (Calgary U.), Carlos Hernandez. (PUJaveriana)

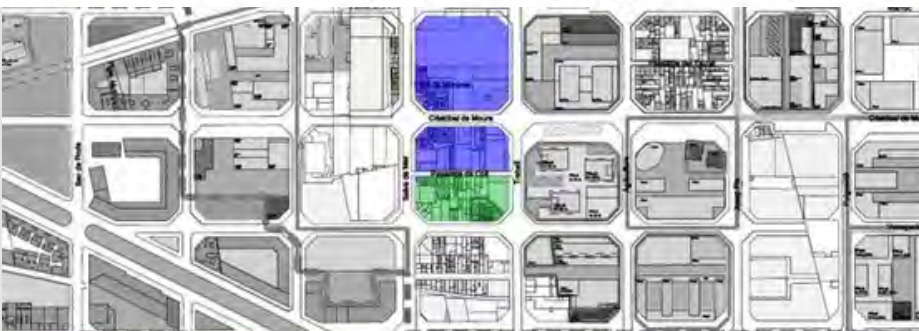

UIA BCN < Verano 2011. "Territorios sustentables en 22@, Eixample del siglo XXI"

Taller de Proyectos + Seminario de Sistemas Urbanos + Viaje de estudios